

**Diamant – Eindringkörper**

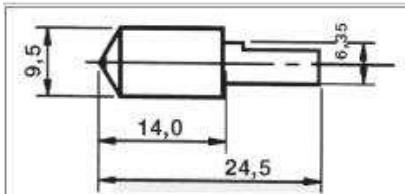

Rockwell 120°  
Alle Typen

Vickers 136°  
z. B. Frank

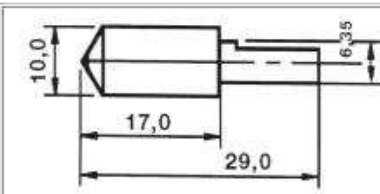

Rockwell 120°  
Wolpert Testor

Vickers 136°  
Wolpert Dia-Testor

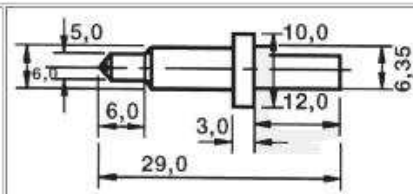

Rockwell 120°  
Testor Automat

Vickers 136°  
Testor Automat

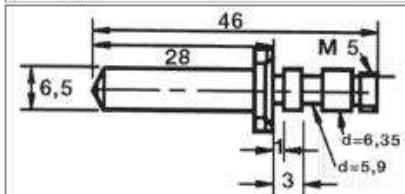

Rockwell 120°  
Reicherter UVN

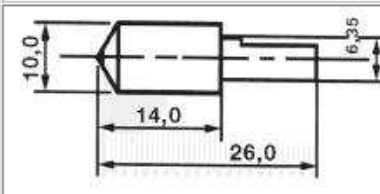

Rockwell 120°  
z. B. Wilson/EMCO

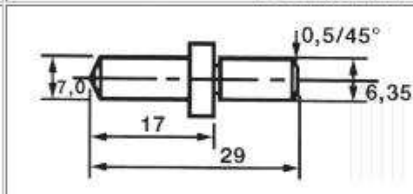

Rockwell 120°  
WPM

Vickers 136°  
WPM

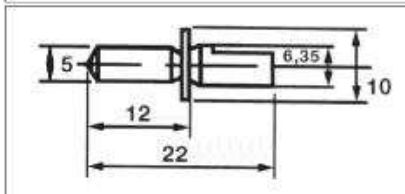

Vickers 136°  
Zwick 1

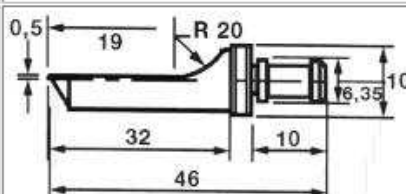

Vickers 136°  
Zwick 2

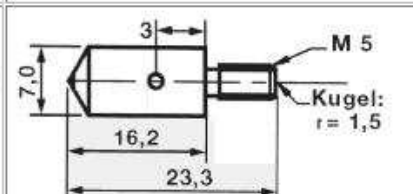

Rockwell 120°  
Dorernst

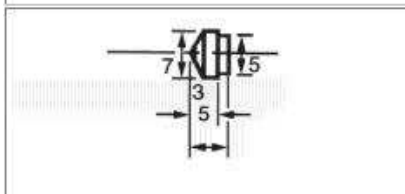

Vickers 136°  
Einsatz Briviskop

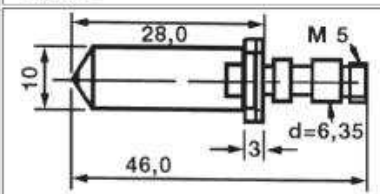

Rockwell 120°  
BRIRO E (Schwerlast)

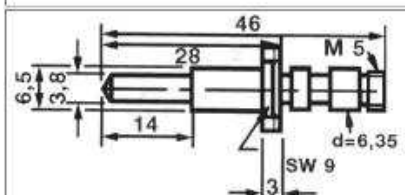

Rockwell 120°  
Sonderhalter

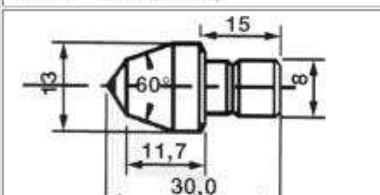

Radius 0,2 Winkel 120°  
Scratch-Tester CSEM

**HINWEIS:**

Alle Eindringkörper werden grundsätzlich mit DKD - Kalibrierschein geliefert. Bei Rockwell-Eindringkörpern ist zusätzlich eine Funktionsprüfung im Lieferumfang enthalten

**SCHÜTZ + LICHT**  
Prüftechnik GmbH

Hansastr. 19c D-40764 Langenfeld  
Fon: +49 (0) 21 73 / 91 93 90  
Fax: +49 (0) 21 73 / 91 93 9 26  
Home: www.schuetz-licht.de  
E-Mail: info@schuetz-licht.de